



D. Auxiliary Pump Change

Change Summary

1. This change applies to TA6 and TA9 Models.
2. The auxiliary hydraulic pump has been updated to a higher specification pump. New hoses are required if an old style pump is removed and the new style fitted.
3. There is also a new gasket to be used between the pump and the engine gearcase.
4. Safety Considerations if changing the auxiliary pump.

Warning:

- Do not work on or around hydraulic systems without wearing safety glasses. Failure to follow this instruction may result in personal injury.

Caution:

- If serious hydraulic pump failure is suspected, do not run the hydraulic pump for longer than is absolutely necessary to determine its condition. If metal fragments are found in the hydraulic lines, oil reservoir, hydraulic pump outlet port, suction screen and/or return oil filter. DO NOT restart the hydraulic pump. Replace the hydraulic pump and clean the hydraulic system.

Note:

- Be prepared for some fluid loss. Collect the fluid in a suitable container and dispose of the fluid in an appropriate manner.

Pressure Relief Valve Pressure Test

- Release the pressure from the hydraulic system-
Park the machine on firm level ground.
Switch off the engine.
Operate the skip control lever in all directions to release internal pressure.

Caution:

- Make sure the engine is not running before isolating the battery in order to avoid damage to the vehicle electrical system.

5. Parts Kit Required to Change Auxiliary Pump – (Kit M1008469-PTO)

- M1008469 1 AUX - PUMP
- M1008552 1 HOSE TAIL STRAIGHT
- W613 1 HYD UNION 3/4 BSPMX1/2 BSPM
- M1008509 1 HOSE ASS'Y - SKIP CONTROL VALVE (Fitted to TA9/9MDX)
- 020-1120 1 BONDED SEAL 1" BSP
- W518 1 3/4" BONDED SEAL
- MS103-30 2 DURLOK SCREW - FLANGED HEX HD M10x30 G12.9 (Torque up to 57Nm)
- M1008508 1 HOSE ASS'Y - SKIP CONTROL VALVE (Fitted to TA6/6MDX)
- M1008653 1 Aux pump gasket



MECALAC

6. Images Of Auxiliary Pump Parts/ Arrangement

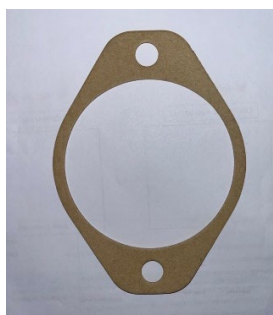
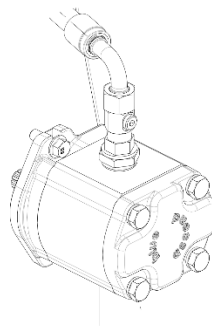
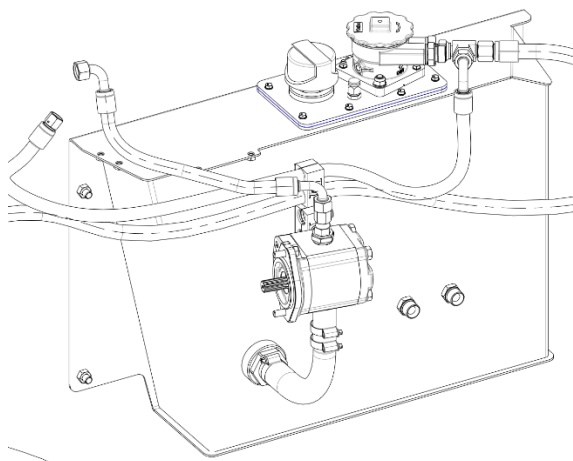

Old Paper Gasket = M1003904

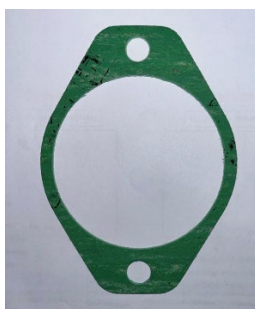

New Fibre Gasket = M1008653



7. Notes Around Re-Assembly Of Aux Pump

Clean the surfaces: Remove any old gasket material, grease/Oil and dirt from the surfaces where the Gasket will be fitted. Use a gasket scraper or a solvent cleaner designed for automotive use to ensure a clean surface.

New Gasket (M1008653) must be fitted with the new pump (M1008469) and torque the M10 bolts that fix the hydraulic pump to the engine to 57Nm.

After all the fittings and pipes have been fitted/tightened (Use the above pictures for guidance for assembly) you will need to top up the hydraulic oil (use hydraulic oil specs stated in the Operation manual for the machine) in the hydraulic tank to the max mark on the dipstick and run the machine at idle for 2 minutes to allow the hydraulic system to prime (**check for hydraulic leaks**).

Remove the pressure test port plug (B), install a suitable adaptor & attach a 0-400Bar (0-5800PSI) pressure gauge. Allow the system to warm up to approximately 50-60°C (122-140°F). Next step is to check the max circuit pressure of the hydraulic circuit, Rev Dumper at Max RPM and holding down the skip lower lever to dead end the hydraulics allowing the system to pressurise (Note: Stop skip function immediately if the pressure exceeds maximum system pressure stated in the below table.).

Relief valve is located on the bottom of the skip control valve. If the pressure reading is not to specification, adjust the pressure relief valve.

To increase the pressure- turn the adjusting screw (C) clockwise.

To decrease the pressure- turn the adjusting screw (C) anti-clockwise.

SYNCHRO TRANSMISSION VERSIONS-

6MDX/s 190-200Bar (2755-2900PSI) & 9MDX/s 210-220Bar (3046-3191PSI).

TA6/s 165-175Bar (2392-2537PSI) & TA9/s 200-210Bar (2900-3045PSI).

HYDROSTATIC TRANSMISSION VERSIONS-

6MDXh/s, TA6h/s 165-175Bar (2392-2537PSI) & 9MDXh/s, TA9h 200-210Bar (2900-3045PSI).

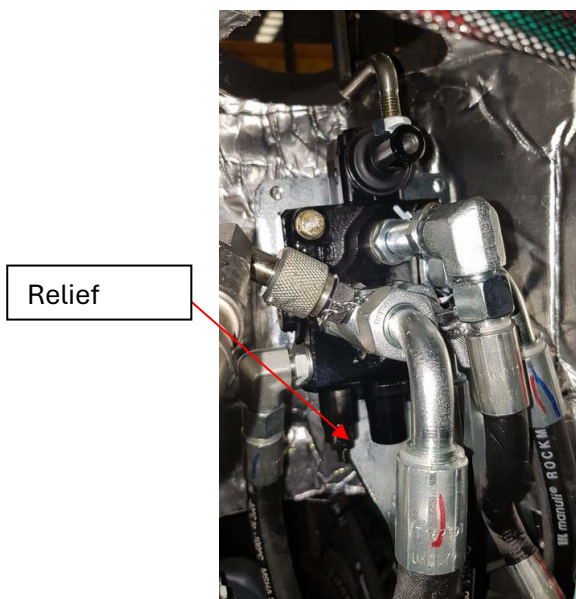

After circuit pressure has been checked, Remove the diagnostic equipment and install/connect the removed items. Start the engine to check machine skip and steering functions (check for oil leaks and check hydraulic tank oil level.)